

1-15DS Global

Shot blasting machine

Technical data	
Working width	380mm
Blasting capacity	up to 250m ² /h on concrete
Motor	15kW / 400V - 50Hz or 60Hz / 63A - Three phase - 5 pole
Weight	450 kg
Dimensions L / W / H	1800 mm / 570mm / 1200mm
Drive system / speed	Electric / 0.5 - 25 m/min
Push / Pull machine	Pull
Abrasive consumption	10 - 75 gr/m ²
Application	Steel / Concrete / Stone / Asphalt

Options



BDC-854

Options / Accessories	
Dustcollector	BDC-655 / BDC-854
Abrasive S330 / S390 / S460	999-0330 / 999-0390 / 999-0460
20m suction hose Ø150	001112
Magnetic broom R600	001238
Maintenance kit	000117
Personal safety features	On request / See manual



Magnetic broom

The innovators in surface preparation!!!!

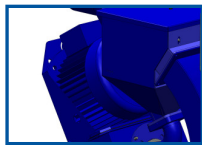

15kW blast motor

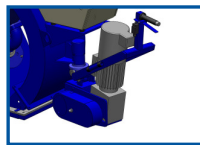

Quick lift system

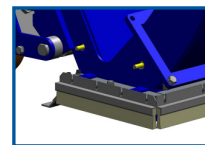

Magnet sealing with brushes

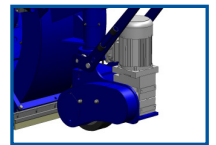

Electric drive system

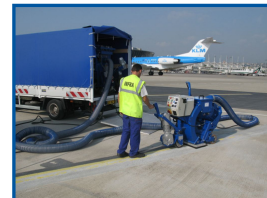
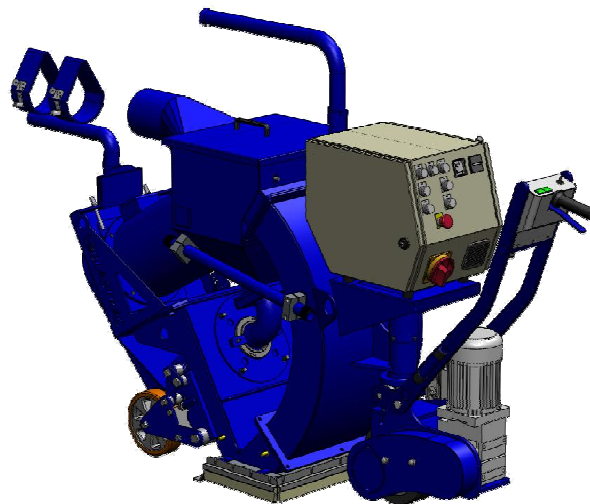

Main assets

- ❖ Closed circuit which is dust free, when connected to an appropriate Blastrac dust collector.
- ❖ Highly versatile machine, appropriate for medium to big jobsite sizes.
- ❖ High quality and strong fabrication.
- ❖ Height adjusting system for easy transport.
- ❖ Ergonomic design and user's friendly control panel.
- ❖ Reliable machine due to proven concept.
- ❖ Easy handle and use.
- ❖ Can be used for floor preparation / renovation / maintenance and decorative purposes.